

Ergofocus glazed Heating range

Available immediately

Production time : 15 weeks from the signed drawing agreement

Please note that production time will be a bit longer for the launch of this model.
The first deliveries from the production site will be at the end of July.

Finish : matte black



Ergofocus glazed
Timeless warmth

The Ergofocus with glass panels joins the Gyrofocus and Domofocus, making all three of Focus's most iconic models now available in a closed version. This expands our range of fireplaces that meet the Ecodesign standard as well as Italy's Four Star (Quattro Stelle) rating, among the most demanding regulations in the world.

The streamlined, ergonomic shape of the Ergofocus remains untouched, and the hearth still pivots 360°. The frameless glass panels slide closed horizontally, offering an unobstructed view of the fire.

The double chamber system uses the same technology as the glazed Gyrofocus and Domofocus (see diagram on p.4). This allows it to achieve exceptional performance, particularly in terms of fine particle emissions, and significantly extends how long the fire burns.

A patent has been filed for this technological innovation.

Performance using wood logs

- heat output = from 6 to 10 kW
- efficiency = 80%
- CO at 13% of O2 = 0,09 % (1187 mg/Nm3)
- NOx at 13% of O2 = 93 mg/Nm3
- OGC at 13% of O2 = 33 mg/Nm3
- dust = 16 mg/Nm3

The closed Ergofocus: as intelligent as it is inspiring.

Dimensions

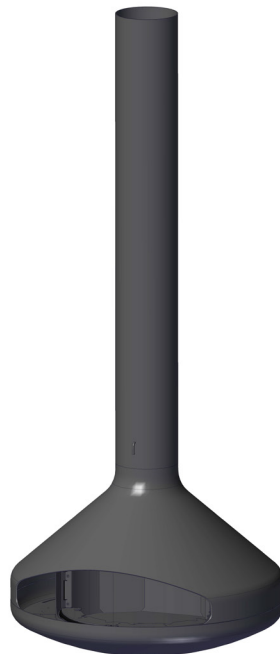
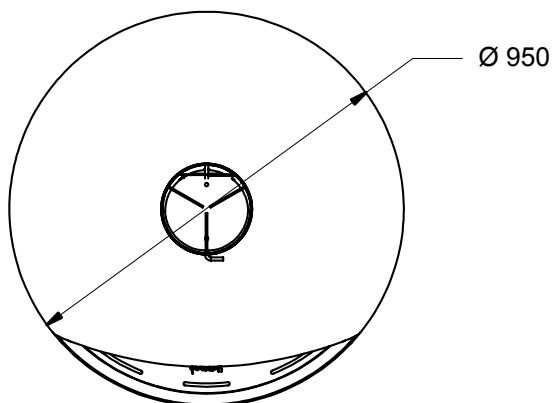
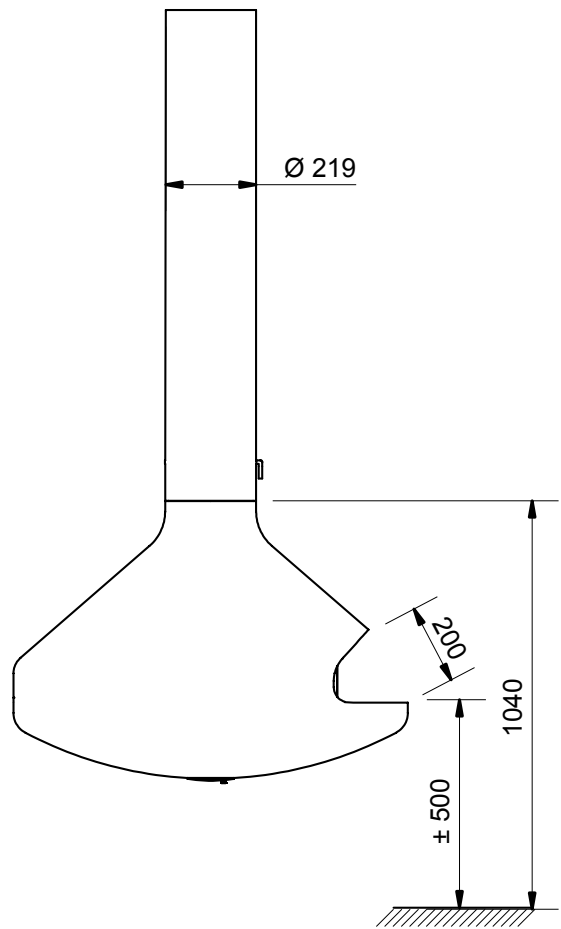
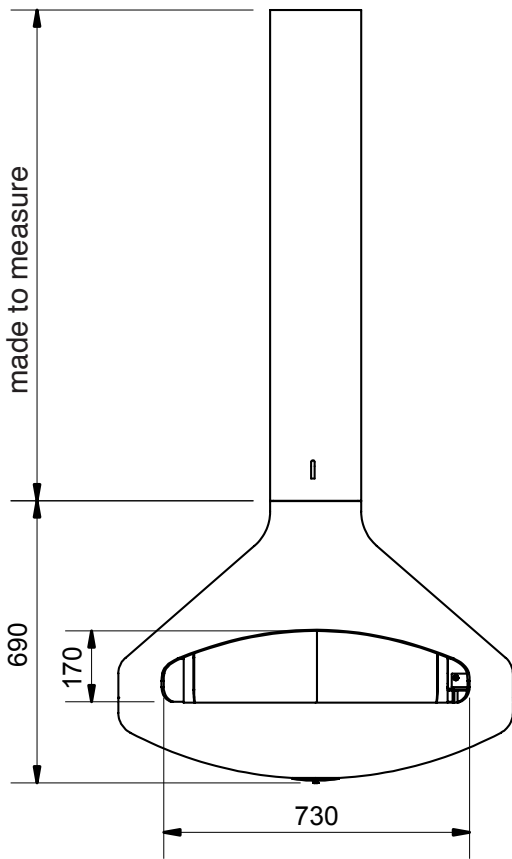

This document is the property of Atelier Dominique Imbert SAS. It contains private and confidential information and is strictly reserved for the use of the Focus partners/dealers it is addressed to. It is strictly prohibited to disclose this document to any third party without our prior authorisation, under penalty of action for damages and prosecution for patent infringement.

Components



This document is the property of Atelier Dominique Imbert SAS. It contains private and confidential information and is strictly reserved for the use of the Focus partners/dealers it is addressed to. It is strictly prohibited to disclose this document to any third party without our prior authorisation, under penalty of action for damages and prosecution for patent infringement.

Technological innovation the double-chamber system

The system consists of:

- a heat-retaining chamber in the original design of the Ergofocus
- an inner combustion chamber with curved heat-resistant glass panels.

This technological innovation optimizes combustion, improving the performance of the fireplace and considerably reducing fine particle emissions.

The fireplace draws combustion air from the room. The combustion air is channelled between the two chambers where it is preheated as it circulates, thus entering the combustion chamber at a higher temperature.

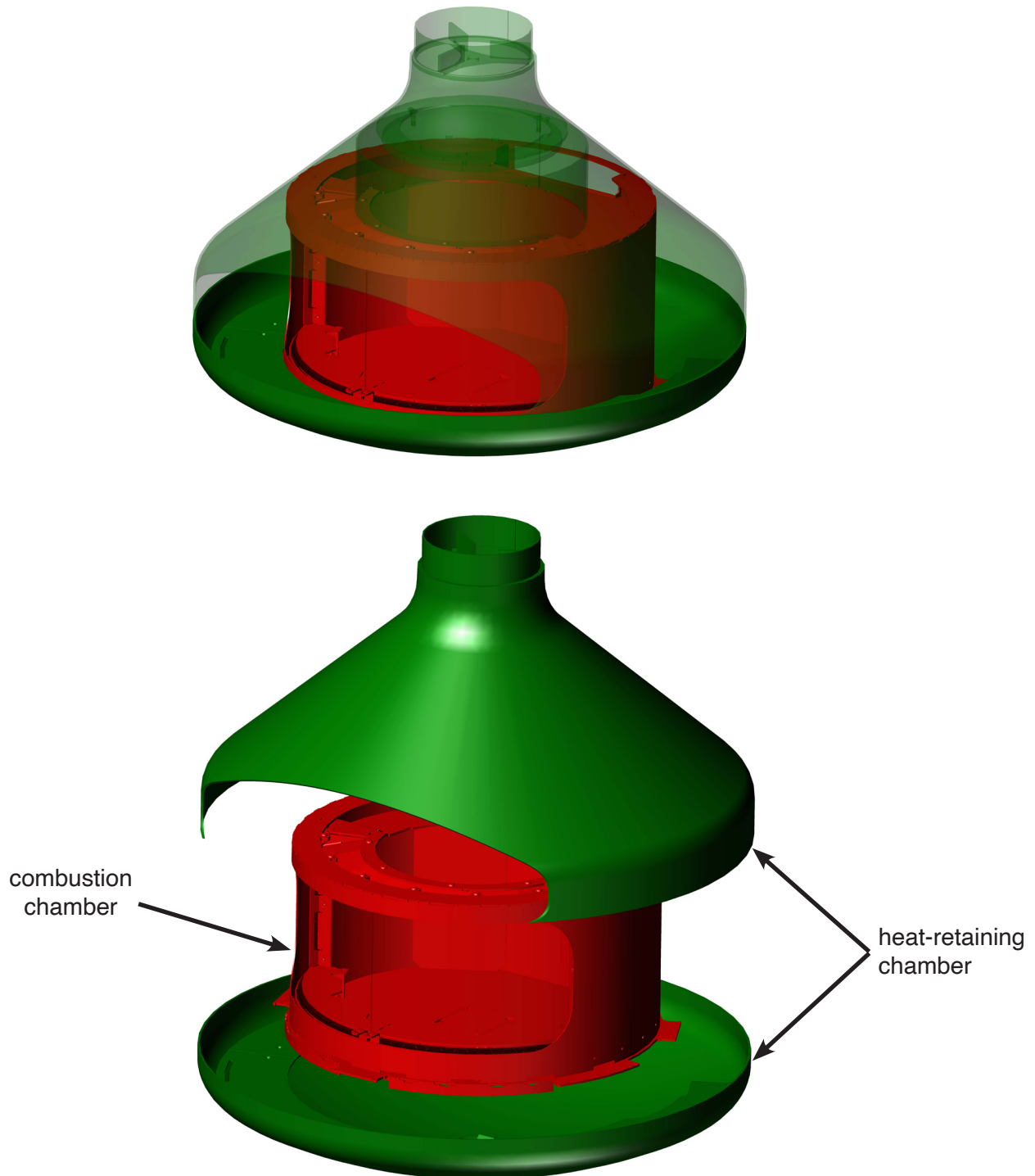

This document is the property of Atelier Dominique Imbert SAS. It contains private and confidential information and is strictly reserved for the use of the Focus partners/dealers it is addressed to. It is strictly prohibited to disclose this document to any third party without our prior authorisation, under penalty of action for damages and prosecution for patent infringement.

installation

In view of the weight of the fireplace (150 kg excluding the flue), a through bolt that links all the elements (flue/flue and flue/plate) is mandatory.

The installation of an anti-sway retaining bracket is recommended when the ceiling height is greater than 3.5m.

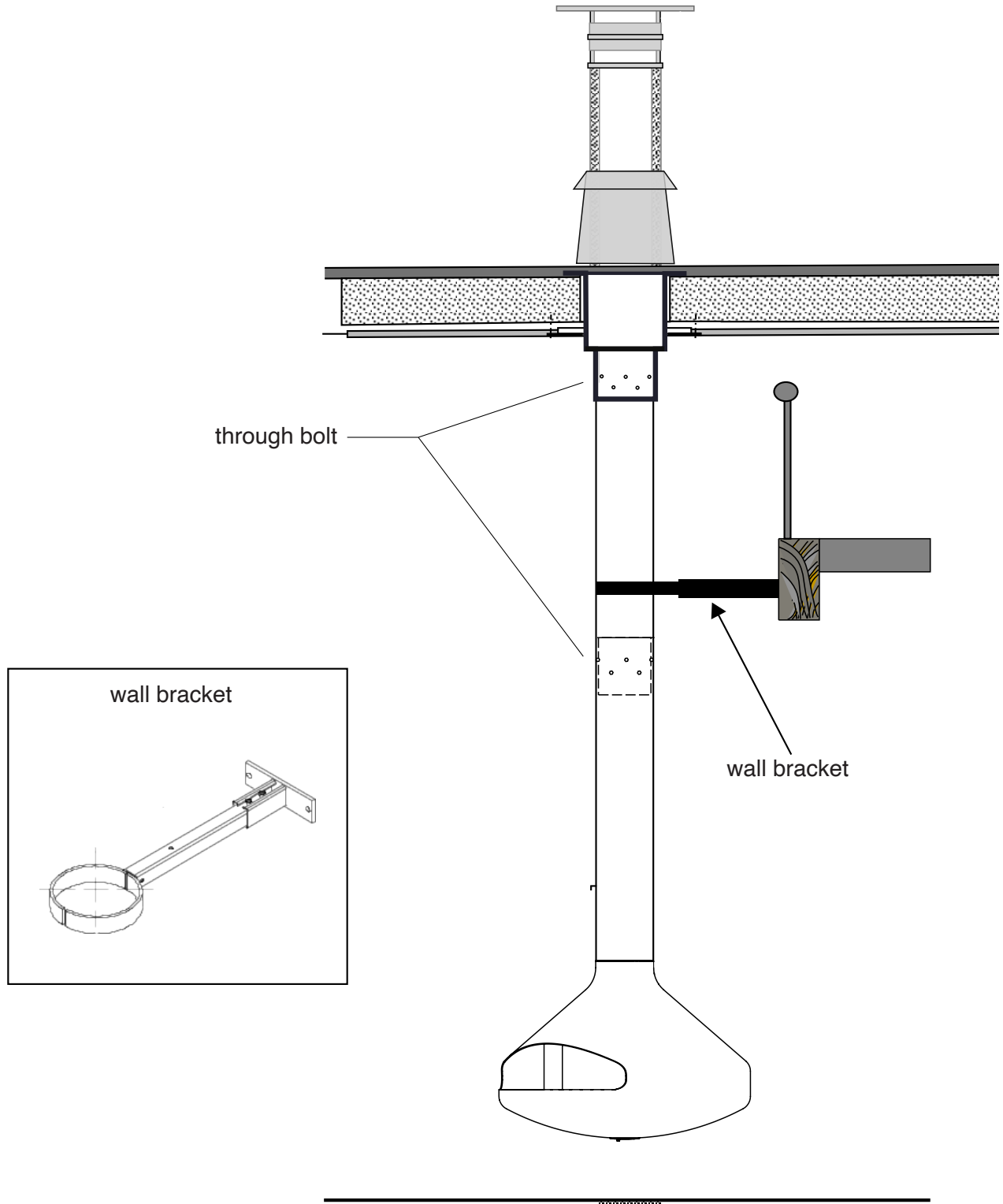

This document is the property of Atelier Dominique Imbert SAS. It contains private and confidential information and is strictly reserved for the use of the Focus partners/dealers it is addressed to. It is strictly prohibited to disclose this document to any third party without our prior authorisation, under penalty of action for damages and prosecution for patent infringement.

Packaging



outer dimensions of the crate: 1050 x 1050 x 1100 de haut

crate weight including the hearth: 170 kg

hearth weight (without packaging): 150 kg

flue pipe weight (without packaging): 16 kg per linear meter